

## Equal High Pressure (mains) Installation:

Install mixer as supplied

## Unequal Pressure and Equal Low Pressure Installation:

Remove Flow Restricted Aerator by unscrewing the Spout Endcap and replace with Unrestricted Aerator supplied in the kit. Refit in reverse order reusing the existing Seal.

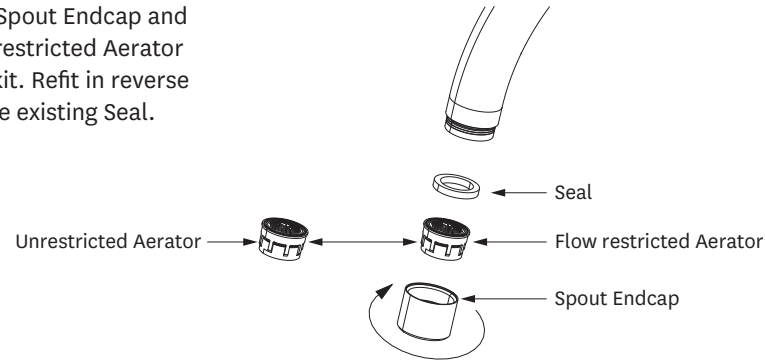

## Unequal Pressure Installation:

Fit the Cold Water Adaptor (supplied in the kit) between the cold water flexible hose and the cold water supply.

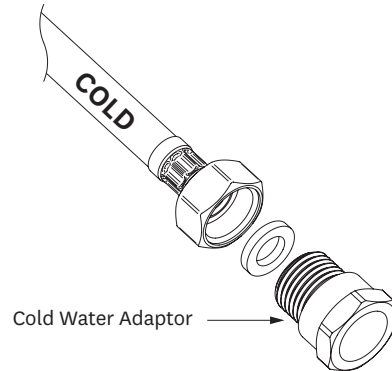

Methven warrants this product against manufacturing defects and that it is suitable for use under the general operating conditions specified in this instruction sheet. However, regional regulations apply and may affect your warranty. Please refer to [www.methven.com](http://www.methven.com) or call customer service for full details.

New Zealand  
0800 804 222

Australia  
13 14 16

UK  
0800 195 1602

IS 1912

ISSUE A

# MINIMALIST MK2 GOOSENECK SINK MIXER

## Installation Guide

### Technical Specifications:

#### Operating Pressure:

Min: 35kPa/0.35bar  
Max: 1000kPa/10bar\*  
Optimum: 35kPa/0.35bar - 500kPa/5bar

#### Operating Temperature:

Hot: Max 80°C\*  
Cold: Min 5°C

#### Inlet Connections:

All 1/2" BSP

Max mounting surface thickness: 50mm

\* Regional specific regulations apply.  
Please refer to your warranty statement at  
[www.methven.com](http://www.methven.com)

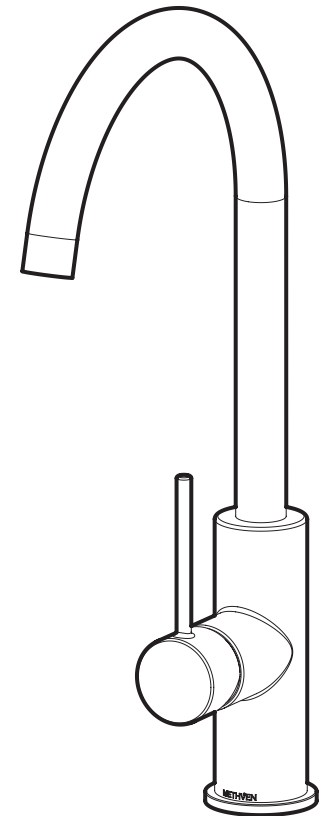

**METHVEN**  
[www.methven.com](http://www.methven.com)

**IMPORTANT:** Please read all of the instructions before installation.

**General:**

- Methven recommends this product is installed by a licensed plumber in compliance with all relevant regional regulations.
- Do not hydrostatic test the installation with this mixer installed. Damage to the ceramic cartridge may occur.
- All pipe work must be thoroughly flushed prior to the installation of the mixer.
- In-line filters must be fitted on both hot and cold supplies to prevent foreign particles damaging the ceramic cartridge.
- Do not remove the ceramic cartridge from the mixer when installing.
- After installation all connections must be checked for leaks.
- All outlets used primarily for personal hygiene shall deliver water at a safe temperature as per regional regulations.
- This mixer is not recommended for use in uncontrolled heating systems such as wet-backs or solar heating units unless a suitable tempering valve is fitted.
- If limited water flow is experienced, locate aerator and filter washers and clean away foreign material as required.
- It is the responsibility of the installer to ensure a waterproof seal is achieved between the product and mounting surface. If in doubt about the quality of the seal, remove the product and reinstall using silicone to ensure a seal is achieved.

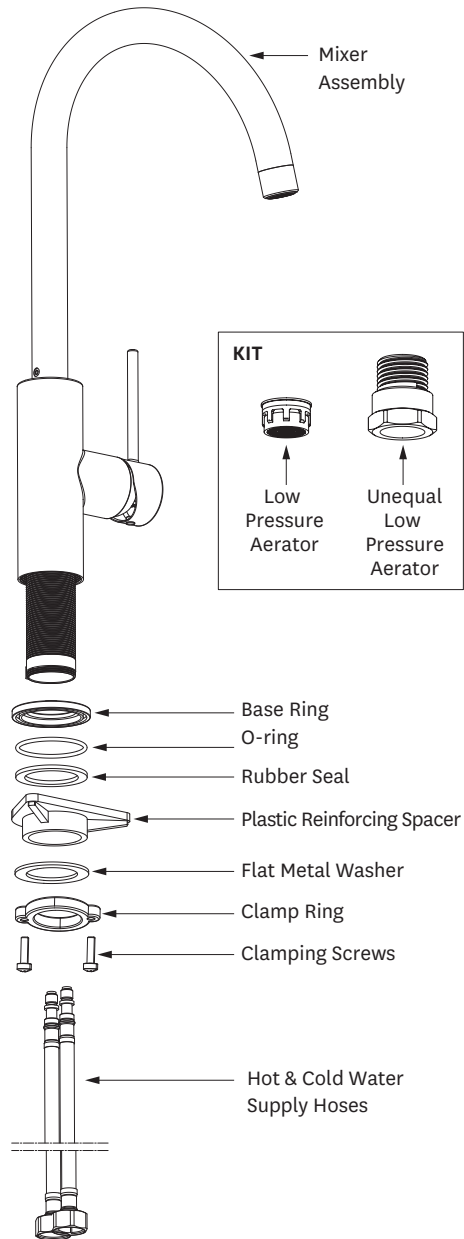

**Care and Cleaning:**

- Never use abrasives or abrasive cleaning agents to clean this product. Clean regularly with contamination free warm soapy water and a damp soft cloth.

**Important:** Before you begin, turn off the water supply. It is recommended to fit isolation valves to both the hot and cold supply.

**Installation:**

1. Cut a 35mm diameter hole through the bench top. Maximum bench thickness is 42mm.
2. From the fixing pack, fit the O-ring into the base of the base ring and fit assembly to the threaded tube until the base ring contacts the underside of the body.
3. Fit mixer to bench top starting by inserting the threaded tube into the deck hole.
4. Once mixer is positioned correctly, from the underside of the bench, fit the rubber seal followed by the metal washer until they contact the underside of the deck. Screw the clamp ring onto the threaded tube until it contacts the flat washer. Equally tighten the three clamp screws until the mixer is firmly clamped to the deck. **DO NOT OVERTIGHTEN.** Note: If mounting to thin deck materials such as a stainless-steel sink, then the plastic reinforcing spacer should be used between the rubber seal and the flat washer for added rigidity.
5. Apply lubrication (silicon grease or approved equivalent) to O-rings of hot (red) and cold (blue) water flexible hoses. Screw hot water inlet hose (red) into the port on the underside of the mixer body indicated with a red dot. Screw cold water supply hose into the remaining port.
6. Connect the hot and cold hoses to the pre-flushed supply connections. Turn on water supplies and check installation for leaks.

**For Low Equal Pressure Installations** – Remove installed Mains Pressure Aerator (See back page) and replace with Low Pressure Aerator supplied in the kit.

**For Low Unequal Pressure Installations** – Remove installed Mains Pressure Aerator (See back page) and replace with Low Pressure Aerator supplied in the kit. Fit Unequal Low Pressure Adaptor supplied in the kit between the flexible cold-water hose and cold-water supply connection.

